

# GUILDHALL

SALES & LETTINGS



GUILDHALL  
SALES & LETTINGS

## 14 Kingsway

Ashton-On-Ribble, Preston, PR2 1SP

Offers Over £190,000



Charming Three Bedroom Semi-Detached Home in a Sought-After Residential Location

Nestled within a popular and well-established area of Ashton-on-Ribble, this delightful three-bedroom semi-detached property offers a wonderful opportunity for those seeking a comfortable and inviting family home.

The property welcomes you through a bright entrance hallway, leading into a spacious and tastefully presented reception room, perfect for relaxing or entertaining. The fitted kitchen provides practical workspace and enjoys views over, with access to, the rear garden, creating a pleasant hub for day-to-day living.

To the first floor, the home continues to impress with three well-proportioned bedrooms, all offering flexible accommodation, alongside a family bathroom.

Externally, the property boasts a private driveway providing convenient off-road parking. To the rear, an enclosed garden offers a peaceful outdoor retreat — ideal for summer evenings, family gatherings, or simply



GUILDHALL  
SALES & LETTINGS

GUILDHALL  
SALES & LETTINGS

GUILDHALL  
SALES & LETTINGS

## Ground Floor

Entrance Hallway 8'26 x 8'00 (2.44m x 2.44m)

Reception Room 18'5 x 10'81 (5.61m x 3.05m)

Kitchen 9'81 x 7'89 (2.74m x 2.13m)

## First Floor

Bedroom One 11'13 x 9'18 (3.35m x 2.74m)

Bedroom Two 10'92 x 8'70 (3.05m x 2.44m)

Bedroom Three 7'99 x 6'94 (2.13m x 1.83m)

Bathroom 7'90 x 5'31 (2.13m x 1.52m)

## Area Map



## Floor Plans

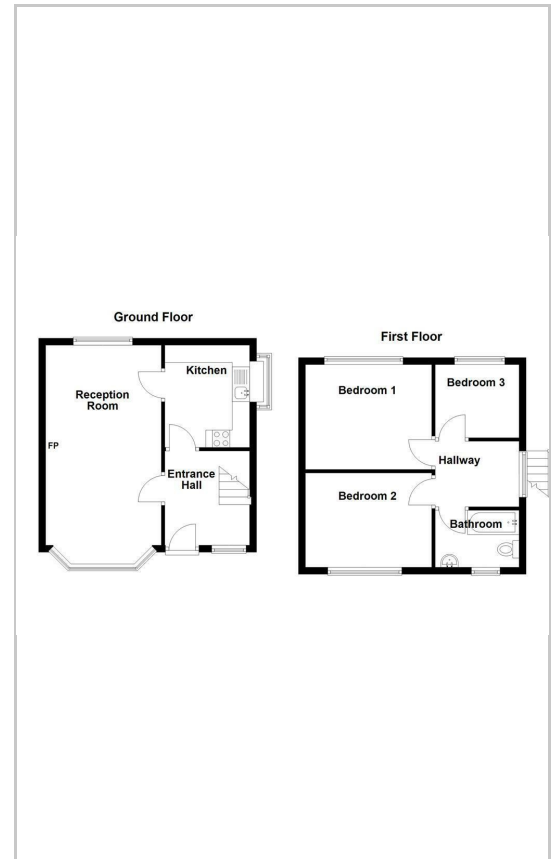

## Energy Efficiency Graph

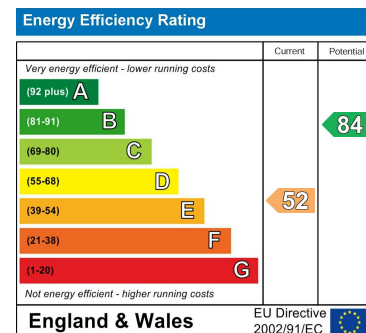

These particulars, whilst believed to be accurate are set out as a general outline only for guidance and do not constitute any part of an offer or contract. Intending purchasers should not rely on them as statements of representation of fact, but must satisfy themselves by inspection or otherwise as to their accuracy. No person in this firm's employment has the authority to make or give any representation or warranty in respect of the property.

441 Blackpool Road, Preston, PR2 2LE

Tel: 01772769999 Email: <https://guildhalllettings.co.uk/>